

Сварочные горелки MIG/MAG /
MIG/MAG Welding Torches

TBi Basic Line



Сварочные горелки MIG/MAG/ MIG/MAG Welding Torches

Basic Line

Особенности и преимущества

- Kostengünstiges Basisprodukt / осн.изделие экономкласса
- Надежная, хорошо зарекомендовавшая себя техника
- Эргономичная ручка с шаровым шарниром
- Высокостойкий шланговый пакет
- Стандартные расходные части

Features and Advantages

- *Economic basic product line*
- *Robust and well-proven technology*
- *Ergonomic handle with ball joint*
- *Very resistant cable assembly / coaxial cable*
- *Standard consumables*

Горелки с воздушным охлаждением / Gas cooled torches



TBi Basic 150
35% (10 мин.)
Mix: 150 A
CO₂: 180 A
Ø 0.6 - 1.0 мм

Страница / Page 3



TBi Basic 240
35% (10 мин.)
Mix: 220 A
CO₂: 250 A
Ø 0.8 - 1.2 мм

Страница / Page 4



TBi Basic 250
35% (10 мин.)
Mix: 200 A
CO₂: 230 A
Ø 0.8 - 1.2 мм

Страница / Page 5



TBi Basic 260
35% (10 мин.)
Mix: 240 A
CO₂: 270 A
Ø 1.0 - 1.2 мм

Страница / Page 6



TBi Basic 360
35% (10 мин.)
Mix: 300 A
CO₂: 330 A
Ø 1.0 - 1.6 мм

Страница / Page 7

Горелки с водяным охлаждением / Water cooled torches



TBi Basic 411
100% (10 мин.)
Mix: 330 A
CO₂: 360 A
Ø 1.0 - 1.6 мм

Страница / Page 8



TBi Basic 511
100% (10 мин.)
Mix: 350 A
CO₂: 380 A
Ø 1.0 - 1.6 мм

Страница / Page 9

Направляющие каналы / Wire guides



Страница / Page 10

TBi Basic 411

water cooled
 Mix: 330 A (100 %)
 CO₂: 360 A (100 %)
 1.0 – 1.6

Basic Line

| | | |
|---------------|---|------------|
| TBi Basic 411 | 3 | 133P4U1030 |
| TBi Basic 411 | 4 | 133P4U1040 |
| TBi Basic 411 | 5 | 133P4U1050 |

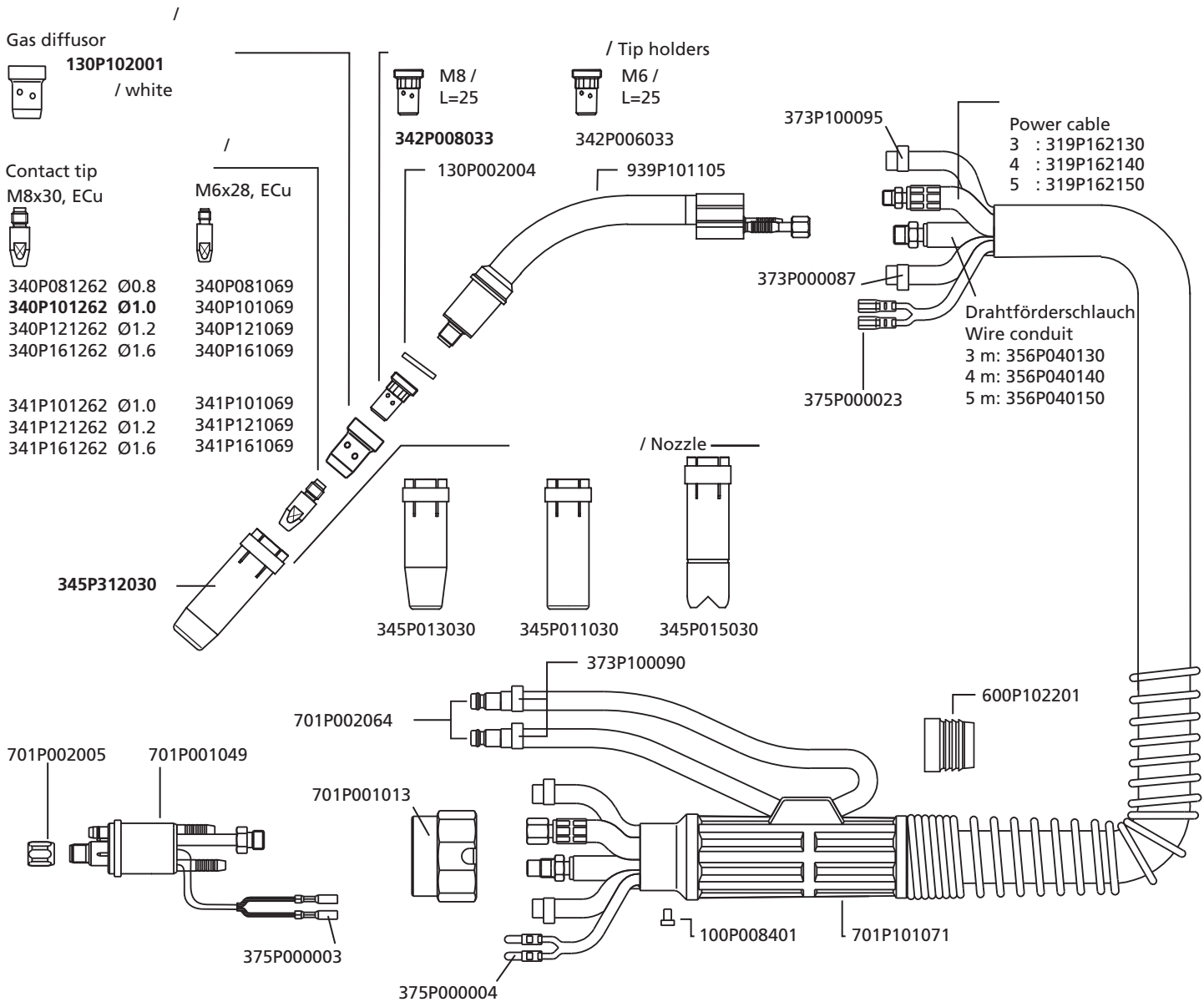

380P220503

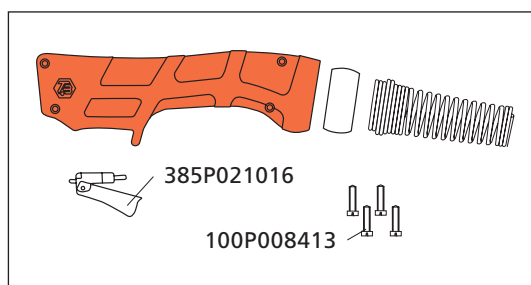

TBi Basic 511

wassergekühlt / water cooled
 Mix: 350 A (100 %)
 CO₂: 380 A (100 %)
 1.0 – 1.6 mm

Basic Line

| | | |
|---------------|-----|------------|
| TBi Basic 511 | 3 m | 134P4U1030 |
| TBi Basic 511 | 4 m | 134P4U1040 |
| TBi Basic 511 | 5 m | 134P4U1050 |

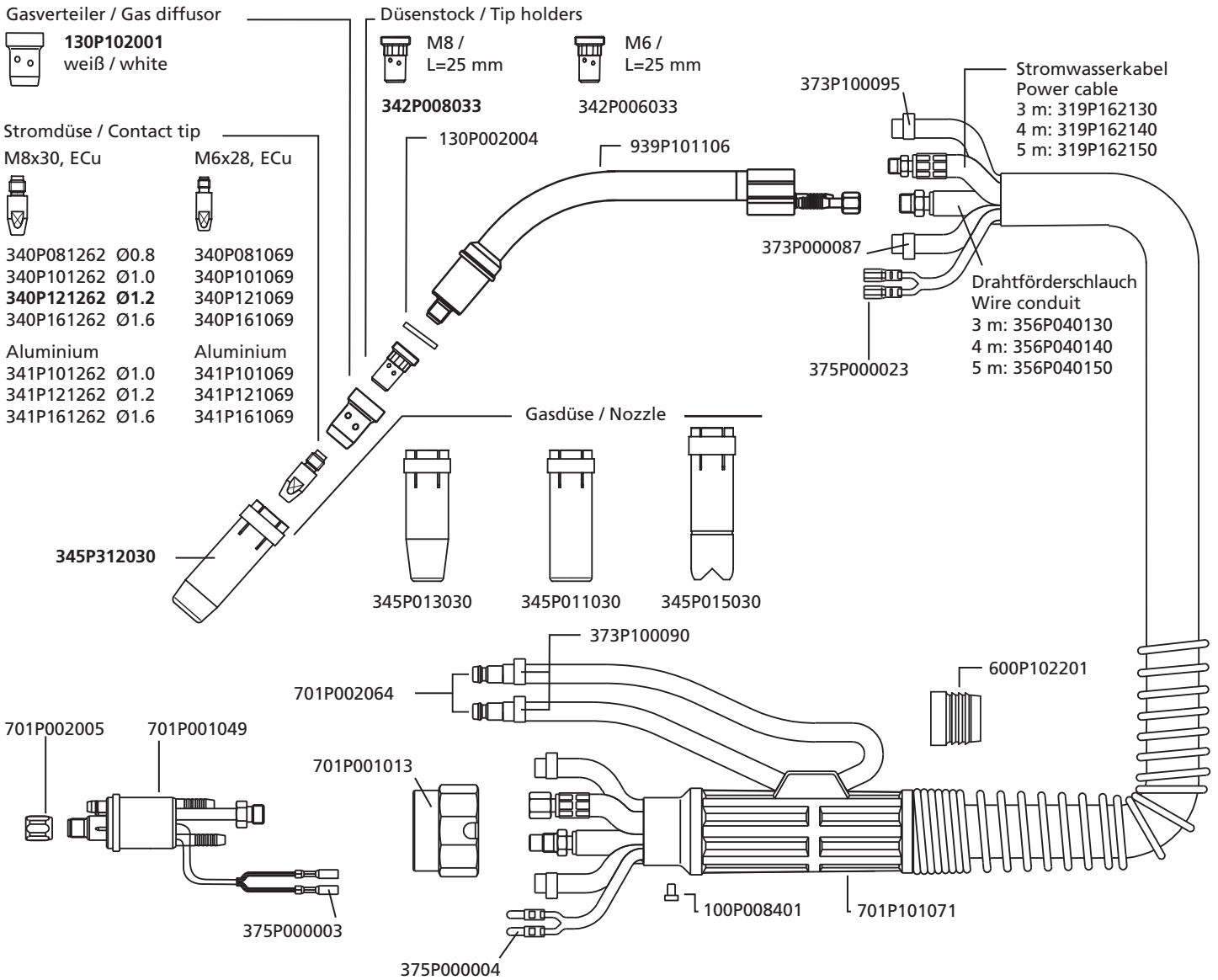

380P220503

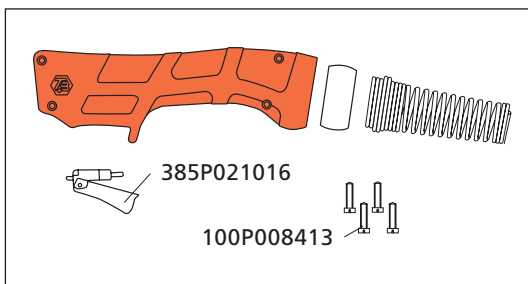

Drahtführungen / Wire guides

Basic Line

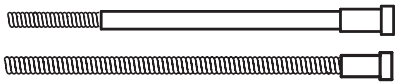
|  | | Brenner gasgekühlt / gas cooled torches | Brenner wassergekühlt / water cooled torches | für Draht / for wire | Farbe / color | Artikel Nr. / Part no. |
|---|--|--|---|-------------------------|---------------------------|---------------------------|
| für Stahldraht / for steel wire | Drahtführungsspiralen isoliert / <i>insulated liners</i> | <input checked="" type="checkbox"/> | <input checked="" type="checkbox"/> | 0.6 - 0.9 | weiß / <i>white</i> | 324P1338_4* |
| | | <input checked="" type="checkbox"/> | <input checked="" type="checkbox"/> | 0.8 - 1.0 | blau / <i>blue</i> | 324P1545_4* |
| | | <input checked="" type="checkbox"/> | <input type="checkbox"/> | 1.0 - 1.2 | rot / <i>red</i> | 324P2045_4* |
| | | <input checked="" type="checkbox"/> | <input type="checkbox"/> | 1.2 - 1.6 | gelb / <i>yellow</i> | 324P2545_4* |
| | Drahtführungsspiralen blank / <i>not insulated liners</i> | | <input checked="" type="checkbox"/> | 1.0 - 1.2 | blank / <i>not insul.</i> | 322P2045_4* |
| | | | <input checked="" type="checkbox"/> | 1.2 - 1.6 | blank / <i>not insul.</i> | 322P2545_4* |
| für Edelstahldraht / for stainless steel wire | Drahtführungsspiralen blank / <i>not insulated liners</i> | | <input type="checkbox"/> | 0.8 - 1.2 | blank / <i>not insul.</i> | 321P2250_4 |
| | | | <input type="checkbox"/> | 1.6 - 2.0 | blank / <i>not insul.</i> | 321P3550_4 |

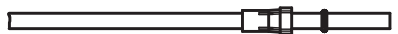
|  | | Brenner gasgekühlt / gas cooled torches | Brenner wassergekühlt / water cooled torches | für Draht / for wire | Farbe / color | Artikel Nr. / Part no. |
|---|--|--|---|----------------------------|-------------------------------|---------------------------|
| für Aluminium und Edelstahldraht / for aluminum and stainless steel wire | PA-Seelen / <i>PA liners</i> | | <input checked="" type="checkbox"/> | 1.0 - 1.2 | anthrazit / <i>anthracite</i> | 328P2040_5* |
| | | | <input checked="" type="checkbox"/> | 1.2 - 1.6 | anthrazit / <i>anthracite</i> | 328P2347_5* |
| | PTFE-Seelen / <i>PTFE liners</i> | | <input type="checkbox"/> | 0.8 - 1.0 | blau / <i>blue</i> | 326P1540_5* |
| | | | <input type="checkbox"/> | 1.0 - 1.2 | rot / <i>red</i> | 326P2040_5* |
| | | | <input type="checkbox"/> | 1.2 - 1.6 | gelb / <i>yellow</i> | 326P2747_5* |
| | | | <input type="checkbox"/> | 1.2 - 1.6 | gelb / <i>yellow</i> | 326P2747_5* |
| | Kohle PTFE-Seelen / <i>Carbon-PTFE liners</i> | | <input type="checkbox"/> | 0.8 - 1.0 | schwarz / <i>black</i> | 327P1540_5* |
| | | | <input type="checkbox"/> | 1.0 - 1.2 | schwarz / <i>black</i> | 327P2040_5* |
| | | | <input type="checkbox"/> | 1.2 - 1.6 | schwarz / <i>black</i> | 327P2747_5* |
| | CeraGlide mit Stahlspitze / <i>CeraGlide with steel tip</i> | | <input type="checkbox"/> | 1.0 - 1.2 | bordeaux / <i>bordeaux</i> | 326P2040_K* |
| | | <input type="checkbox"/> | 1.2 - 1.6 | bordeaux / <i>bordeaux</i> | 326P2347_K* | |

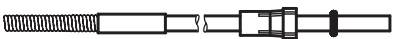
|  | | Brenner gasgekühlt / gas cooled torches | Brenner wassergekühlt / water cooled torches | für Draht / for wire | Farbe / color | Artikel Nr. / Part no. |
|---|---|--|---|-------------------------|-------------------------------|---------------------------|
| für Aluminium und Edelstahldraht / for aluminum | PA-Seelen mit Bronzespirale / <i>PA liners with bronze liner</i> | <input checked="" type="checkbox"/> | <input type="checkbox"/> | 1.0 - 1.2 | anthrazit / <i>anthracite</i> | 328P2040_A* |
| | | <input checked="" type="checkbox"/> | <input type="checkbox"/> | 1.2 - 1.6 | anthrazit / <i>anthracite</i> | 328P2347_A* |
| | PTFE-Seelen mit Bronze- spirale / <i>PTFE liners with bronze liner</i> | <input type="checkbox"/> | <input type="checkbox"/> | 0.8 - 1.0 | blau / <i>blue</i> | 326P1540_A* |
| | | <input type="checkbox"/> | <input type="checkbox"/> | 1.0 - 1.2 | rot / <i>red</i> | 326P2040_A* |
| | | <input type="checkbox"/> | <input type="checkbox"/> | 1.2 - 1.6 | gelb / <i>yellow</i> | 326P2747_A* |
| | | <input type="checkbox"/> | <input type="checkbox"/> | 1.2 - 1.6 | gelb / <i>yellow</i> | 326P2747_A* |
| | CeraGlide mit Bronzespirale / <i>CeraGlide with bronze liner</i> | <input type="checkbox"/> | <input type="checkbox"/> | 1.0 - 1.2 | bordeaux / <i>bordeaux</i> | 326P2040_H* |
| | | <input type="checkbox"/> | <input type="checkbox"/> | 1.2 - 1.6 | bordeaux / <i>bordeaux</i> | 326P2347_H* |

Empfohlen / *recommended* Optional / *optional*

* Bitte an Leerstelle entsprechende Angaben über Brennerlänge machen, z.B 3, 4 oder 5 für 3 m, 4 m oder 5 m lange Brenner. /
At the blank, please insert suitable information for torch length, e.g. 3, 4 or 5 for 3 m, 4 m or 5 m long torches.

Ready for Tomorrow.

© 2015 TBi Industries GmbH. Alle Rechte vorbehalten. Technische Änderungen vorbehalten. Kopie oder Nachdruck auch auszugsweise nicht gestattet. / All rights reserved. Subject to change without notice. Excerpts and reprints not permitted. Nr. DOKP11230A, 07/2015.

TBi Industries GmbH
Ruhberg 14
D-35463 Fernwald-Steinbach
Postfach 67
D-35461 Fernwald-Steinbach

Tel. + 49 6404 9171-0
Fax. + 49 6404 9171-58
Internet: www.tbi-industries.com
E-mail: info@tbi-industries.com